

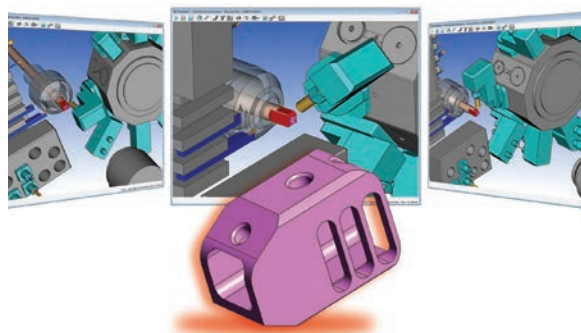

Advanced Manufacturing Solutions

PartMaker 2015



World leading CAM software for Production Machining

www.partmaker.com

PartMaker 2015 - More Power and Control for Your CNC Applications

PartMaker 2015 gives you more power and flexibility to program your parts faster and more productively. Support for the latest breed of sophisticated, multi-axis machine tools assures your company will stay ahead of the competition as your parts and machines get more complex. Greater control assures you will be able to program your parts just the way you want to.

PartMaker 2015 extends the software's patented technology for automating the programming of multi-axis lathes and its unique knowledge based machining approach to assure your organization greater productivity in CNC programming.

New features and enhancements include:

- ▶ Innovative Approach to Multi-Axis Post Processing
- ▶ Unique Support for Vertical Mill-Turns
- ▶ Improved Simulation of New Machine Architectures
- ▶ Turning Toolpath Improvements
- ▶ New Method for Tool Feed & Speed Control
- ▶ Hole Making and Canned Cycle Improvements
- ▶ More Powerful and Flexible Post Processor Customization



PartMaker/SwissCAM Post Processor Reference Guide

Machine Manufacturer	Program	Machine Model	URL
Control Manufacturer	Factory	Control Series	URL

Machine Layout

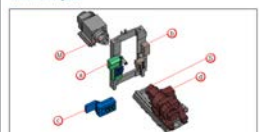

Tool Post	Tool Range*	Auto Spindle	Sub Spindle
Gang Slide	0-8	Yes	Yes
Gang Slide #2	11-15, 18-19, 21-23, 45-49	Yes	Yes
Back Working	01-02	Yes	Yes
End Working	01-02	Yes	No

Machining Functions Support

Machining Function	Main Spindle	Sub Spindle
Turn	Yes	Yes
M04 End Index	Yes	Yes
M04 End Stop	Yes	Yes
M04 Cham. Profile	Yes	Yes
M04 Cham. Index	Yes	Yes
M04 Cylinder	Yes	Yes
M04 XZ Plane	Yes	Yes
M04 ZY Plane	Yes	Yes
M04 XY Plane	Yes	Yes
M04 3 Axis Plane	Yes	Yes

*In order for the post processor to work correctly, your Process Table must begin with a turning process on the Main Spindle.

Synchronization Modes Support

Mode	Main Spindle			Sub Spindle		
	Turning	Milling	Turning	Turning	Milling	
MT00	Yes	Yes	Yes	Yes	Yes	
MT01	-	-	Yes	Yes	Yes	
MT10	Yes	Yes	Yes	Yes	Yes	
MT15	Yes	Yes	Yes	Yes	Yes	
MT20	Yes	Yes	Yes	Yes	Yes	
MT25	Yes	No	Yes	Yes	No	

Post Processing for Multi-Axis Lathes

Automatically generate descriptive "Post Processor Reference Guides" in either HTML or MS Word format which include a pictorial diagram of your machine tool and clearly explain the capability of your multi-axis post processor.

Vertical Mill Turns

Specialist CAM interface which addresses the programming, simulation and post processing aspects of VMTs.

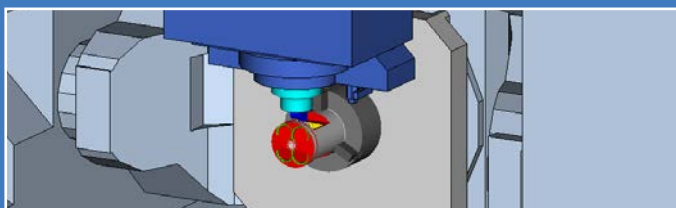

Visit
www.delcam-ams.com
www.delcam.tv

Learn
www.partmaker.com
<http://LZ.partmaker.com>

Contact
info@partmaker.com
1-888-270-6878

Tool Feed and Speed Control

Enhanced Knowledge Based Machining methodology for managing feeds and speeds for a variety of cutting tools.

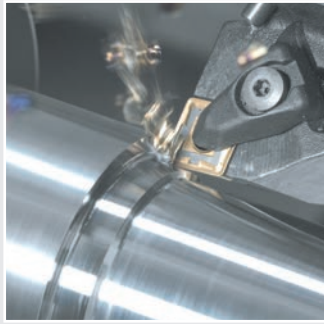

Hole Making and Canned Cycle Improvements

Addition of chip breaking helical milling and variable peck depth functionality for hole making operations.

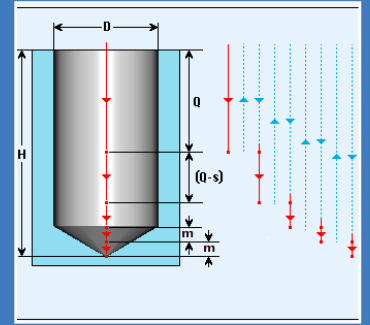

Improved Turning Toolpath Strategies

More powerful machining strategies for modern turning operations such as support of Stock Models for Rough Turning.

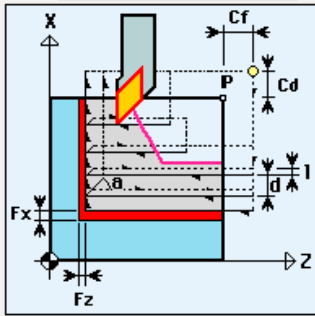

New Machine Architectures

Improved support for both programmable and fixed angled turret tooling attachments for Turn-Mill Centers and Swiss-type lathes.

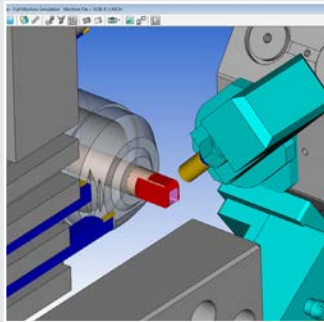

Head Table 5-Axis Mills

Support for 5-axis mills with tilting tool heads and rotary tables, including nutating heads.

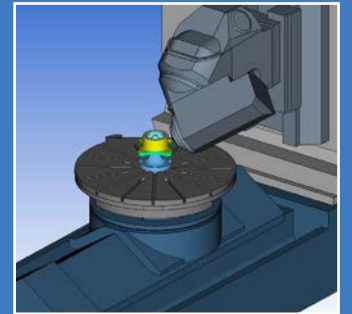

More Flexible Post Processor Customization

ConfigPost now supports significantly more variables, user conditions and canned cycle types.

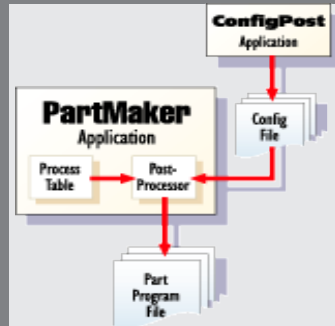

I find that every year, PartMaker delivers a superior product with its new releases

Otto Nellesen, Price Products
www.partmaker.com/video/priceproducts

For more information about PartMaker, visit www.partmaker.com

Unlock the power of Delcam software



LEARNING ZONE

Visit www.delcam.tv/lz and see how Delcam software could benefit your business!